



Alaska Alcoholic Beverage Control Board

Form AB-01: Transfer License Application

This transfer license application form is required for all individuals or entities seeking to apply for the transfer of ownership and/or location of an existing liquor license. Applicants should review **Title 04** of **Alaska Statutes** and **Chapter 305** of the **Alaska Administrative Code**. All fields of this form must be completed, per AS 04.11.260, AS 04.11.280, AS 04.11.290, 3 AAC 305.045 and 3 AAC 305.060.

This form must be completed and submitted to AMCO's Anchorage office, along with all other required forms and documents before any license application will be considered complete.

Section 1 – Transferor Information

Enter information for the **current** licensee and licensed establishment.

Licensee:	JPS ENTERPRISES INC	License #:	5884		
License Type:	Restaurant / Eating Place	Statutory Reference:			
Doing Business As:	Golden China				
Premises Address:	231 W. Front St				
City:	Nome	State:	AK	ZIP:	99762
Local Governing Body/Bodies:	City of Nome				

Transfer Type:

- ☒ Regular transfer
- ☐ Transfer with security interest
- ☐ Involuntary retransfer
- ☐ Controlling interest transfer
- ☐ Location transfer

OFFICE USE ONLY

Complete Date:		Transaction #:	
Board Meeting Date:		License Years:	
Issue Date:		Examiner:	



Alaska Alcoholic Beverage Control Board

Form AB-01: Transfer License Application**Section 2 – Transferee Information**Enter information for the **new** applicant and/or location seeking to be licensed.

Licensee:	An & Kang LLC				
Doing Business As:	Golden China				
Premises Address:	231 Front St.				
City:	Nome	State:	AK	ZIP:	99762
Community Council, (If applicable):	N/A				

Mailing Address:	PO Box 1812				
City:	Nome	State:	AK	ZIP:	99762
Email:	ankangllc@gmail.com	Phone:	907-434-6936		

Designated Licensee:	Ki Ho Kang		
Contact Phone:	907-434-6936	Business Phone:	907-443-2300
Contact Email:	ankangllc@gmail.com		

Seasonal License? Yes ☐ No ☒ If "Yes", write your six-month operating period: _____

Section 3 – Premises Information

Premises to be licensed is:

☒ an existing facility ☐ a new building ☐ a proposed building

The next two questions must be completed by beverage dispensary (including tourism) and package store applicants only:

What is the distance of the shortest pedestrian route from the public entrance of the building of your proposed premises to the outer boundaries of the nearest school grounds? Include the unit of measurement in your answer (Must be in feet).

What is the distance of the shortest pedestrian route from the public entrance of the building of your proposed premises to the public entrance of the nearest church building? Include the unit of measurement in your answer (Must be in feet.)



Alaska Alcoholic Beverage Control Board

Form AB-01: Transfer License Application**Section 4 – Sole Proprietor Ownership Information**

This section must be completed by any sole proprietor who is applying for a license. Entities should skip to Section 5.

If more space is needed, please attach a separate sheet with the required information.

The following information must be completed for each licensee and each affiliate (spouse).

This individual is an: ☐ applicant ☐ affiliate

Name:					
Address:					
City:		State:		ZIP:	
Email:		Phone:			

This individual is an: ☐ applicant ☐ affiliate

Name:					
Address:					
City:		State:		ZIP:	
Email:		Phone:			

Section 5 – Entity Ownership Information

This section must be completed by any entity, including a corporation, limited liability company (LLC), partnership, or limited partnership, that is applying for a license. Sole proprietors should skip to Section 6.

If more space is needed, please attach a separate sheet with the required information.

- If the applicant is a corporation, the application shall be executed by an authorized officer of the Corporation. Information must be completed below for each **stockholder who owns 10% or more** of the stock in the corporation, and for each **president, vice-president, secretary, and managing officer**.
- If the applicant is a limited liability organization, whether manager managed or member managed, the following information must be completed for each **member with an ownership interest of 10% or more** and for each **manager regardless of ownership share**.
- If the applicant is a partnership, including a **limited partnership**, the following information must be completed for each **partner with an interest of 10% or more**, and for each **general partner**.
- For any entity, identify all affiliates for your organization as defined at 3 AAC 305.950.

Entity Official:	Cain An				
Title(s):	Manager	Phone:	907-443-2300	% Owned:	60
Address:	PO BOX 1812				
City:	Nome	State:	AK	ZIP:	99762
Email:	ankangllc@gmail.com	Phone:	907-443-2300		



Alaska Alcoholic Beverage Control Board

Form AB-01: Transfer License Application

Entity Official:	Ki Ho Kang				
Title(s):	Member	Phone:	907-434-6936	% Owned:	40%
Address:	PO Box 1812				
City:	Nome	State:	AK	ZIP:	99762
Email:	ankangllc@gmail.com	Phone:	907-434-6936		

Entity Official:					
Title(s):		Phone:		% Owned:	
Address:					
City:		State:		ZIP:	
Email:		Phone:			

Entity Official:					
Title(s):		Phone:		% Owned:	
Address:					
City:		State:		ZIP:	
Email:		Phone:			

This subsection must be completed by any applicant that is a corporation or LLC. Corporations and LLCs are required to be in good standing with the Alaska Division of Corporations (DOC). The registered agent is either an individual resident of the state or domestic corporation authorized to transact business in the state and whose business office is the same as the registered office.

CBPL Entity #:	10237549	AK Formed Date:	06/28/2023	Home State:	Alaska
Registered Agent:	Hojin Park	Agent's Phone:	907-350-9292		
Agent's Mailing Address:	PO Box 231944				
City:	Anchorage	State:	AK	ZIP:	99523
Email:	hojinp.cpa@gmail.com	Phone:	907-350-9292		

Residency of Agent: Alaska

Yes No

Does your registered agent satisfy the requirement of AS 04.11.430?

☒☐



Alaska Alcoholic Beverage Control Board

Form AB-01: Transfer License Application

Section 6 – Other Licenses

Ownership and financial interest in other alcoholic beverage businesses:

Yes

No

Does any representative or owner named as a transferee in this application have any direct or indirect financial interest in any other alcoholic beverage business that does business in or is licensed in Alaska?

☐☒

If “Yes”, disclose which individual(s) has the financial interest, what the type of business is, and if licensed in Alaska, which license number(s) and license type(s):

Section 7 – Authorization

Communication with AMCO staff:

Yes

No

Does any person other than a licensee named in this application have authority to discuss this license with AMCO staff?

☒☐

If “Yes”, disclose the name of the individual and the reason for this authorization:

Hojin Park, hojinp.cpa@gmail.com

Accountant who has more knowledge about the alcohol and restaurant business.



Alaska Alcoholic Beverage Control Board

Form AB-01: Transfer License Application

Section 8 – Transferor Certifications

Additional copies of this page may be attached, as needed, for the controlling interest of the current licensee to be represented.

I declare under penalty of perjury that the undersigned represents a **controlling interest** of the current licensee. I additionally certify that I, as the current licensee (either the sole proprietor or the controlling interest of the currently licensed entity) have examined this application, approve of the transfer of this license, and find the information on this application to be true, correct, and complete.

Signature of transferor

Sunny K Song
Printed name of transferor

Subscribed and sworn to before me this 15th day of January, 2025.

Signature of Notary Public



Notary Public in and for the State of California.

My commission expires: 09/29/2028

Signature of transferor

JASON M SONG
Printed name of transferor

Subscribed and sworn to before me this 15th day of January, 2025.

Signature of Notary Public



Notary Public in and for the State of California.

My commission expires: 09/29/2028



Alaska Alcoholic Beverage Control Board

Form AB-01: Transfer License Application

Section 8 – Transferor Certifications

Additional copies of this page may be attached, as needed, for the controlling interest of the current licensee to be represented.

I declare under penalty of perjury that the undersigned represents a **controlling interest** of the current licensee. I additionally certify that I, as the current licensee (either the sole proprietor or the controlling interest of the currently licensed entity) have examined this application, approve of the transfer of this license, and find the information on this application to be true, correct, and complete.



Signature of transferor

Peter Sanghoon Lee

Printed name of transferor

Subscribed and sworn to before me this 16th day of January, 2025.



Signature of Notary Public



Notary Public in and for the State of California.

My commission expires: 09/29/2028

Signature of transferor

Printed name of transferor

Subscribed and sworn to before me this _____ day of _____, 20____.

Signature of Notary Public

Notary Public in and for the State of _____.

My commission expires: _____



Alcohol and Marijuana Control Office
550 W 7th Avenue, Suite 1600
Anchorage, AK 99501
alcohol.licensing@alaska.gov
<https://www.commerce.alaska.gov/web/amco>
Phone: 907.269.0350

Alaska Alcoholic Beverage Control Board

Form AB-01: Transfer License Application

Section 9 – Transferee Certifications

Read each line below, and then sign your initials in the box to the right of each statement:

Initials

I certify that all proposed licensees (as defined in AS 04.11.260) and affiliates have been listed on this application.

K-H

I certify that all proposed licensees have been listed with the Division of Corporations.

K-H

I certify that I understand that providing a false statement on this form or any other form provided by AMCO is grounds for rejection or denial of this application or revocation of any license issued.

K-H

I certify that all licensees, agents, and employees who sell or serve alcoholic beverages or check the identification of a patron will complete an approved alcohol server education course, if required by AS 04.21.025, and, while selling or serving alcoholic beverages, will carry or have available to show a current course card or a photocopy of the card certifying completion of approved alcohol server education course, if required by 3 AAC 305.700.

K-H

I agree to provide all information required by the Alcoholic Beverage Control Board in support of this application.

K-H

I hereby certify that I am the person herein named and subscribing to this application and that I have read the complete application, and I know the full content thereof. I declare that all the information contained herein, and evidence or other documents submitted are true and correct. I understand that any falsification or misrepresentation of any item or response in this application, or any attachment, or documents to support this application, is sufficient grounds for denying or revoking a license/permit. I further understand that it is a Class A misdemeanor under Alaska Statute 11.56.210 to falsify an application and commit the crime of unsworn falsification.

K-H

I certify that I and any individual identified in the business entity ownership section of this application, has, or will read AS 04 and its implementing regulations.

K-H

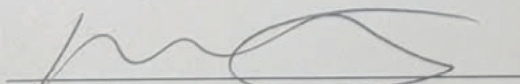
Signature of transferee
Kiho Kang
Printed name

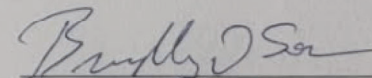
Signature of Notary Public

Notary Public in and for the State of Alaska

My commission expires: With Office

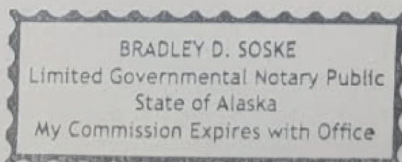

Subscribed and sworn to before me this 5th day of March, 2025

AMCO Recieved 3-25-2025

Received by AMCO 8.22.25



Alaska Alcoholic Beverage Control Board

Restaurant Endorsement Application

This endorsement application form is required to apply for a restaurant endorsement to support your underlying license or pending license application. Applicants should review and become familiar with AS 04.09.450, **Title 04 of Alaska Statutes** and **Chapter 305 of the Alaska Administrative Code**. This form must be completed and submitted along with all other required forms and documents before any endorsement application will be considered complete and placed in the queue for our licensing examiners review.

Section 1 – Establishment and Contact Information

Enter information for the **current** licensee and licensed establish.

Licensee:	An & Kang LLC	License #:	5884
Doing Business As:	Golden China	License Type:	Restaurant/Eating Place
Licensee Mailing Address:	PO Box 1812	Phone Number:	907-443-2300
Full Premises Address:	231 Front St.		
City:	Anchorage	State:	AK
		ZIP:	99762
Local Governing Body:	City of Nome	Email:	ankangllc@gmail.com

Section 2 – Endorsement Requested

Restaurant Endorsement:	AS 04.09.450. A restaurant endorsement authorizes the holder of a beverage dispensary license, fair license, golf course license, sporting activity or event license, club license, outdoor recreation lodge license, destination resort license, or beverage dispensary tourism license. The biennial fee for a restaurant endorsement is \$200 with a \$25 application fee.	
-------------------------	---	--

An application for a restaurant endorsement must specify the establishment or portion of the establishment that constitutes a bona fide restaurant, that there is supervision on the premises adequate to reasonably ensure that a person under 21 years of age will not obtain alcoholic beverages. This **endorsement** application is for the request of a designation as a bona fide restaurant, hotel, or eating place for purposes of AS 04.16.010(c) or AS 04.16.049, and for the request of the following designation(s) (check all that apply):

- ☐ Dining after standard closing hours: AS 04.16.010(c)
- ☐ Dining by persons 16 – 20 years of age: AS 04.16.049(a)
- ☒ Dining by persons under the age of 16 years, accompanied by a person over the age of 21: AS 04.16.049(a)
- ☐ Employment for any persons under 21 years of age: AS 04.16.049(c)

NOTE: Under AS 04.16.049(d), a Department of Labor and Workforce Development work permit is not required to employ a person 18 - 20 years of age.

Section 3 – Access to Persons Under 21 Years of Age

Review AS 04.16.049(a); AS 04.16.049(c)

Be specific in your list where within the premises persons under 21 years of age are anticipated to have access in the course of either dining or employment as designated in Section 2. (Example: Persons under 21 years of age will only be allowed in the dining area OR will only be employed and present in the kitchen).

Individuals under the age of 16 shall be permitted in the dining area only when accompanied by a person who is at least 21 years of age. Access to and employment within the kitchen shall be restricted to individuals who are 21 years of age or older



Alaska Alcoholic Beverage Control Board

Restaurant Endorsement Application

Describe the policies, practices and procedures that will be in place to ensure that persons under 21 years of age do not gain access to alcoholic beverages while dining or employed at your premises. Outline how and where alcoholic beverages are stored on premises. Acknowledge that employees who sell and serve alcoholic beverages must have a current Server Education Card.

See Attached

Is an owner, manager, or assistant manager who is 21 years of age or older always present on the premises during business hours?

Yes



No



Section 4 – Food Service Establishment Permit

Per AS 04.21.080(b) for an establishment to qualify as a bona fide restaurant, a Food Service Permit or (for licenses within the Municipality of Anchorage) corresponding Department of Health and Human Services documentation is required.

Link to the Alaska Department of Environmental Conservation (ADEC) Food Safety Website:

<http://dec.alaska.gov/eh/fss/food/>

Link to the Municipality of Anchorage Food Safety Website:

<http://www.muni.org/Departments/health/Admin/environment/FSS/Pages/fssfood.aspx>

IF you are unable to certify the below statement, please discuss the matter with the AMCO office:

Initials

I have attached a copy of the current food service permit for this premises OR the plan review approval.

KH

**Note: If a plan review approval is submitted, a final permit will be required before finalization of any permit or license application.*

Section 5 – Hours of Operation

Review AS 04.16.010(c).

Include variances in weekend/weekday hours, and indicate AM/PM:

Days/Hours of Operation

Weekday	From Time of Day	To Time of Day
Sunday	Closed	
Monday	11 AM	10 PM
Tuesday	11 AM	10 PM
Wednesday	11 AM	10 PM
Thursday	11 AM	10 PM
Friday	11 AM	10 PM
Saturday	11 AM	10 PM

Policies and Practices

Our establishment maintains strict policies to ensure that persons under 21 years of age do not gain access to alcoholic beverages while dining or employed on the premises.

Dining Area Controls: Guests under the age of 21 are identified through mandatory ID verification at the point of service. Alcoholic beverages are served only by employees. Signage is posted in visible areas reminding patrons that alcoholic beverages will not be served to anyone under the age of 21. Persons under 16 must be accompanied by a person at least 21 years of age while in the dining area.

Employee Restrictions: No persons under the age of 21 is employed

Storage of Alcoholic Beverages: Alcoholic beverages are stored in a secured stockroom and behind the bar in restricted-access areas. Only employees 21 years of age or older are permitted to access or handle alcoholic beverage storage areas. Inventory is monitored and logged regularly to prevent unauthorized access.

Compliance Training and Oversight: All employees receive training regarding state alcohol laws, ID verification procedures, and company policies.

By implementing these policies, practices, and procedures, we ensure that alcoholic beverages are stored securely, served responsibly, and never made accessible to persons under the age of 21.



Alaska Alcoholic Beverage Control Board

Restaurant Endorsement Application

Section 6 – Areas Covered by Endorsement

Does the endorsement apply to your entire licensed premises as approved by the ABC Board?

Yes ☒

No ☐

Does the requested endorsement expand your currently licensed premises?

Yes ☒

No ☐

- If no, attach the approved diagram, no larger than 8 1/2" x 11" of the layout, and identify the portions of the premises covered by various requested endorsements. You must use a solid, contiguous **colored** line in any color other than red to outline the outer perimeter of the area of the premises covered by the requested endorsement(s).
- If endorsements are overlapping, provide a conspicuous means to distinguish each endorsement from the other (e.g., keyed map with varying colors for each requested endorsement).
- **Your drawing MUST include:**
 - Dimensions in feet **not** square feet of all exterior walls and major interior walls (we do not accept diagrams drawn to scale)
 - Include cross-streets
 - A north arrow, and any significant geographical features. Points of reference, such as a compass showing North.
 - All entrances, exits, walls, bars, and fixtures
- **If your premises includes multiple floors, please include a separate diagram of each floor.** You must identify the stairs between each floor, and each hallway/corridor that leads to each set of stairs.
- **Any endorsement application that includes outdoor space** are required to submit a security plan that includes information about the barriers, practices, and personnel that are to be used to ensure that alcohol is not introduced or removed from the permitted premises and to prevent the access of alcohol by a minor during the permitted event. A security plan may be requested for other proposed locations on a case-by-case basis.

Section 7 – Entertainment & Service

Are any forms of entertainment offered or available within the licensed business or within the proposed licensed premises?

Yes ☐

No ☒

If yes, describe the entertainment offered or available and the hours in which the entertainment may occur.

Entertainment as described by AS 04.09.210, includes dancing, karaoke, live performances, or similar activities, but does not include recorded or broadcast performances without live participation.

Food and beverage service offered or anticipated is:

☒ Table Service ☐ Buffet Service ☐ Counter Service ☐ Other: _____



Alaska Alcoholic Beverage Control Board

Restaurant Endorsement Application

Section 8 – Attestations

I certify that I understand that providing a false statement on this form or any other form provided by AMCO is grounds for rejection or denial of this application or revocation of any license issued.

Initials

KH

I certify that all licensees, agents, and employees who sell or serve alcoholic beverages or check the identification of a patron will complete an approved alcohol server education course, if required by AS 04.21.025, and while selling or serving alcoholic beverages, will carry or have available to show a current course card or a photocopy of the card certifying completion of approved alcohol server education course, if required by 3AAC 305.340.

KH

I agree to provide all information required by the Alcoholic Beverage Control Board in support of this application.

KH

I hereby certify that I am the person herein named and subscribing to this application and that I have read the complete application, and I know the full content thereof. I declare that all of the information contained herein, and evidence of other documents submitted are true and correct. I understand that any falsification or misrepresentation of any item or response in this application, or any attachment, or documents to support this application, is sufficient grounds for denying or revoking a license, and or endorsement. I further understand that this is a Class A misdemeanor under AS 11.56.210 to falsify an application and commit the crime of unsworn falsification.

KH

KI HO KANG

Printed name of licensee

Signature of licensee

8/19/2025

Date



Alcoholic Beverage Control Office

Public Notice

Application for Transfer of Ownership

Application ID: 5940
License Type: Restaurant Eating Place License (REPL)
AS 04.09.210
License Number: 5884
Seasonality: Year-round

From Transferor:

Doing Business As: Bering Sea Bar and Grill
Premises Address: 231 Front Street , Nome, AK, 99762, USA
City/Municipality: Nome
Borough: Unorganized Borough

Licensee

Licensee Name: Jps Enterprises Inc
Type: Corporation
Licensee Mailing Address: P.O. Box 1305, Nome, AK, 99762, USA

Entity Officer, Stockholder/Shareholder

Entity Vice President #1

Type: Person
Name: Peter S. Lee
Title: Vice President
Percentage of Ownership: 30%

Entity Secretary #2

Type: Person
Name: Jason Song
Title: Secretary
Percentage of Ownership: 30%

Entity President #3

Type: Person

Name:	Sunny Song
Title:	President
Percentage of Ownership:	40%
Resident Agent's Name:	Jason Song
Agent's Phone Number:	907-304-3351
Agent's Email:	mhsong@email.com
Agent's Address:	PO Box 1305, Nome, AK, 99762, USA
The registered agent is either an individual resident of the state or a domestic corporation authorized to transact business in the state and whose business office is the same as the registered office?	Yes

To Transferee:

Doing Business As:	Golden China
Premises Address:	231 Front Street , Nome, AK, 99762, USA
City/Municipality:	Nome
Borough:	Unorganized Borough

Licensee

Licensee Name:	An & Kang Llc
Type:	Limited liability company
Licensee Email:	ankangllc@gmail.com
Licensee Phone:	907-443-2300
Licensee Mailing Address:	P.O. Box 1812, Nome, AK, 99762, USA

Entity Officer, Stockholder/Shareholder

Entity Manager, Member #1

Type:	Person
Name:	Cain An
Title:	Manager, Member
Percentage of Ownership:	60%
Phone number:	907-443-2300
Email:	ankangllc@gmail.com
Mailing Address:	PO Box 1812, Nome, AK, 99762, USA

Entity Manager, Member #2

Type:	Person
Name:	Ki Kang
Title:	Manager, Member
Percentage of Ownership:	40%
Phone number:	907-434-6936
Email:	ankangllc@gmail.com
Mailing Address:	PO Box 1812, Nome, AK, 99762, USA
Resident Agent's Name:	Hojin Park
Agent's Phone Number:	907-350-9292
Agent's Email:	hojinp.cpa@gmail.com
Agent's Address:	PO Box 231944, Anchorage, AK, 99523, USA
The registered agent is either an individual resident of the state or a domestic corporation authorized to transact business in the state and whose business office is the same as the registered office?	Yes

Interested persons may object to the application by submitting a written statement of reasons for the objection to their local government, the applicant, and the Alcohol & Marijuana Control Office (AMCO). Written comments should be sent to AMCO at alcohol.licensing@alaska.gov or to 550 W 7th Ave. Suite 1600, Anchorage, AK 99501.

Posting Date:



Alaska Alcoholic Beverage Control Board

Form AB-02: Premises Diagram

Why is this form needed?

A detailed diagram of the proposed licensed premises is required for all alcohol license applications, per AS 04.11.260, 3 AAC 305.630 and 3 AAC 305.660. Your diagram must include dimensions and must show all entrances and boundaries of the premises, walls, bars, fixtures, and areas of storage, service, consumption, and manufacturing.

This form must be completed and submitted to AMCO's Anchorage office before any license application will be considered complete. You may attach blueprints or other detailed drawings that meet the requirements of this form.

The diagram **MUST** include:

- You must use a **solid, contiguous red line** to outline the outer perimeter of your premises with no breaks or separations.
 - The red outline is required to follow a physical barrier (wall, fence and even across doorways).
 - There should be no red lines within the perimeter
- Each area should be clearly labeled in any color other than red where alcohol is:
 - Stored
 - Served/Sold
 - Manufactured
 - Consumed
- All diagrams must include:
 - Dimensions (AMCO does not accept diagrams drawn to scale)
 - Cross streets
 - Points of reference, such as a compass rose indicating True North
 - All entrances, exits, walls, bars, and fixtures
- If your premises include multiple floors, please include a separate diagram of each floor.
 - You must identify the stairs between each floor, and each hallway/corridor that leads to each set of stairs.
- If your premises includes multiple floors, please include a separate diagram of each floor. You must identify the stairs between each floor, and each hallway/corridor that leads to each set of stairs.
- If your proposed premises is located within a building or building complex that contains multiple businesses and/or tenants, please provide an additional page that clearly shows the location of your proposed premises within the building or building complex, along with the addresses and/or suite numbers of the other businesses and/or tenants within the building or building complex.
- Any license applications that include outdoor space** are required to submit a security plan that includes information about the barriers, practices, and personnel that are to be used to ensure that alcohol is not introduced or removed from the permitted premises and to prevent the access of alcohol by a minor during the permitted event. A security plan may be requested for other proposed locations on a case-by-case basis.

Section 1 – Establishment Information

Enter information for the business seeking to be licensed, as identified on the license application.

Licensee:	AN & KANG LLC	License Number:	5884
License Type:	Restaurant / Eating Place		
Doing Business As:	Golden China		
Premises Address:	231 W. Front St		
City:	Nome	State:	AK
		ZIP:	99762



Alaska Alcoholic Beverage Control Board

Form AB-02: Premises Diagram

Section 2 – Detailed Premises Diagram

Clearly indicate the boundaries of the premises and the proposed licensed area within that property. See above for detailed instructions.

Please see attached

W Front St. Nome, Alaska

231 W. Front St
Golden China

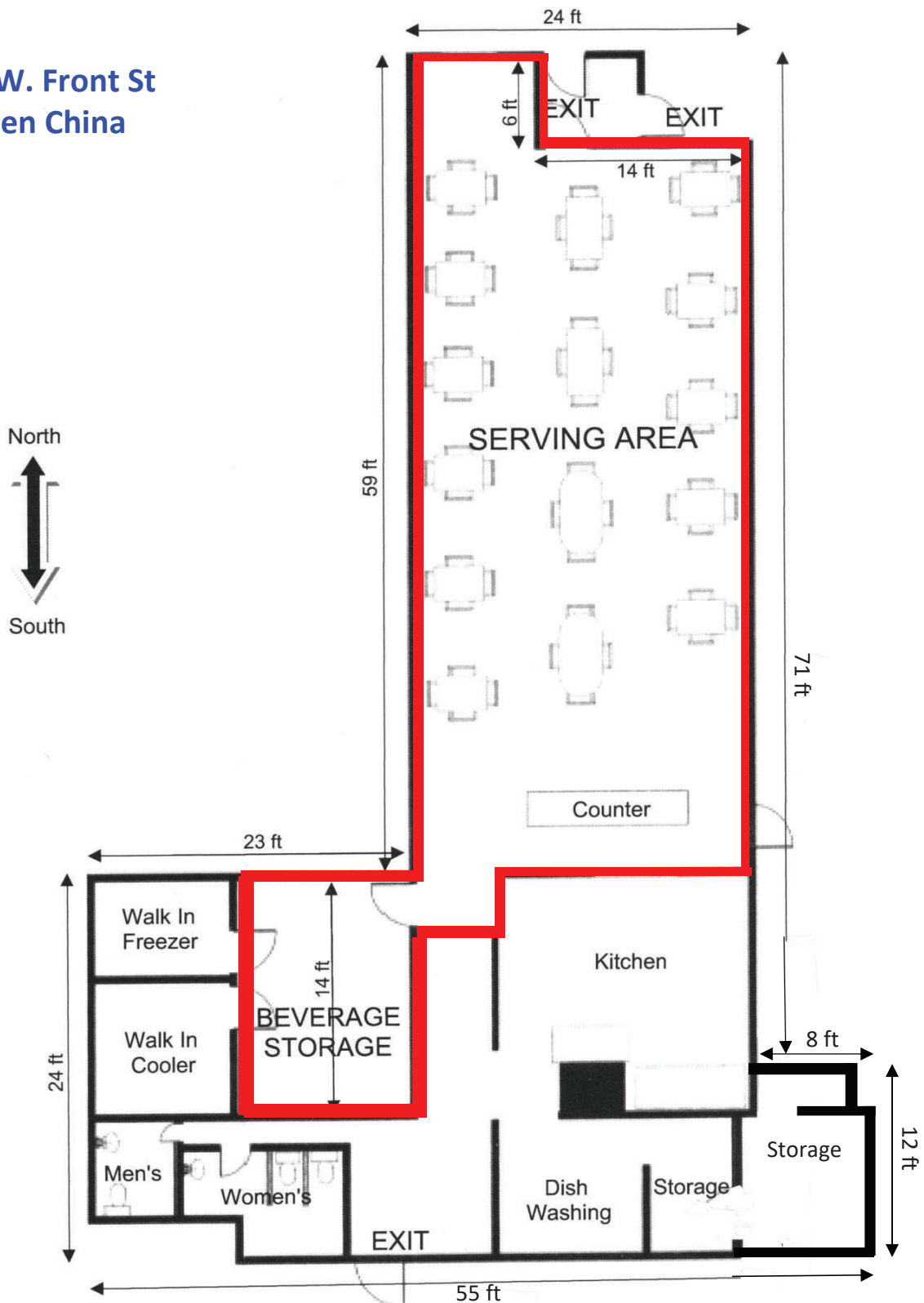

[illegible]

TOTAL FIRST FLOOR AREA = 18,419 SQ. FT.
17,355 SQ. FT. WITH 1,064 SQ. FT. FOR
COMMON STAIRS, SHAFTS & EXTERIOR WALLS.

1
D01

EXISTING 1ST FLOOR PLAN LAYOUT

SCALE: 1" = 12'-0"

NORTH

VERIFY SCALES:
THIS BAR IS
1" ON ORIGINAL
DRAWING, ADJUST
SCALE IF NOT 1"

EXIST'G BLDG CODE ANALYSIS
++APARTMENT ADDITION/RENOVATION
BLOCK H - OLD AC LOT - CITY OF NOME
WOODY SACKETT FRONT ST BLDG
P O BOX 1284 - NOME, AK 99762
TEL: 907-443-4638 FAX: 907-443-4638

**MD RUISEL • ARCHITECT**
PO BOX 1938 • NONE, AK 99762 • (907) 443-2979

ANCHORAGE TEL:
907-323-6368
FAX: 907-443-2979
EMAIL: akars@goi.net

DATE: 05-26-05
PROJECT: 2005.04
SHEET NO. 01
D-01
OF THREE 03



Alaska Food Code 2025 Establishment Permit

Division of Environmental Health
Food Safety & Sanitation Program

Permit Number: 14966
Issued to: **AN & KANG LLC**
For: **GOLDEN CHINA**
For Operation Of: **FF-1 Food Service**
Located at: **231 W Front ST Nome, AK 99762**

This permit, issued under the provisions of 18 AAC 31, is valid until the noted expiration date or unless suspended or revoked by the department.

This permit is not transferable for change of ownership, facility location, or type of operation. It must be posted in plain view in the establishment and is the property of the State of Alaska.

Expiration Date:
December 31, 2025

Program Manager:

A handwritten signature in black ink, appearing to read "Kimberly S. O'Neil", is written over a faint, larger signature.

**If you have questions or concerns regarding safe food handling practices call or text
907-764-9825 or visit our website to file a complaint
(dec.alaska.gov/eh/fss/report-illness-issue/)**



Sushi Rolls

6 pc Sashimi (Raw Fish) *	22	Add sniper Roll	22
6 pc Sushi (Nigiri) *	21	Spicy Tuna Lover *	25
California Roll	17	<i>Spicy tuna, cucumber with spicy tuna, spicy mayo, eel sauce</i>	
<i>Crab meat, avocado, cucumber, sesame seed</i>		Tuna Lover Roll *	26
Spicy California Roll *	18	<i>Spicy tuna, cucumber topped all kind of tuna, sauces</i>	
Golden California Roll	22	Unagi Roll	26
<i>Deep fried California roll with Masago</i>		Pink Roll	25
Crunch Roll	19	<i>Inside: Spicy tuna, cucumber</i>	
<i>Crab, avocado, cucumber covered in crunch, eel sauce</i>		<i>On top: Seared salmon, masago, scallion, spicy mayo</i>	
Orange Roll *	21	Red Dragon *	24
<i>Crab, avocado, cucumber masago, spicy mayo, eel sauce</i>		<i>Inside: Spicy tuna, cucumber</i>	
Salmon Roll *	24	<i>On top: Unagi, avocado, spicy mayo and eel sauces</i>	
Rainbow Roll *	25	Fire Cracker Roll	27
<i>California Roll, On top: 4 kinds of fish, avocado, eel sauce</i>		<i>Inside: Shrimp tempura, crab meat, cucumber, avocado</i>	
Dragon Roll	23	<i>On top: Spicy Tuna, Crunch, Masago, spicy mayo, eel sauce</i>	
<i>Crab meat, avocado, cucumber, Unagi, avocado, eel sauce</i>		Hot Zone	26
Tuna Roll *	22	<i>Spicy tuna, cucumber topped with salmon, jalapeno, hot sauce, spicy mayo, eel sauce</i>	
<i>Crab, avocado, cucumber topped with tuna, sauces</i>		Seared tuna Roll *	24
Spicy Tuna Roll *	23	<i>Spicy tuna, cucumber topped with seared tuna, masago, scallion, spicy mayo, eel sauce</i>	
<i>Crab, avocado, cucumber topped spicy tuna, eel sauce</i>		Shrimp Crunch Roll	22
Yummy Roll	25	<i>Shrimp tempura, crab, cucumber, avocado covered in crunch, spicy mayo, eel sauce</i>	
<i>Cream Cheese, avocado, crab meat, spicy tuna and deep fried crispy with spicy mayo, eel sauce</i>		Green Dragon Roll	25
Philadelphia Roll *	23	<i>Shrimp tempura, crab, cucumber, avocado, eel sauce</i>	
<i>Salmon, cream cheese, cucumber, avocado, sesame seed</i>		Tiger Roll	26
Las Vegas Roll	25	<i>Shrimp tempura, crab, cucumber, avocado topped with shrimps, spicy mayo, eel sauce</i>	
<i>Cream cheese, avocado, crab meat, masago and deep fried crispy with eel sauce</i>		Holiday Roll *	26
Jalapeno on Fire *	26	<i>Inside: Shrimp tempura, cucumber, crab, avocado</i>	
<i>Inside: Crab meat, avocado, cucumber</i>		<i>On top: Seared salmon, spicy mayo, masago, hot sauce, scallion, eel sauce</i>	
<i>Top: Spicy tuna, Jalapeno, hot sauce, spicy mayo, eel sauce</i>		Seaweed Salad Roll	23
Rock & Roll *	26	<i>Shrimp tempura, crab meat, cucumber, avocado topped with seaweed salad</i>	
<i>Inside: Shrimp tempura, crab, cucumber, avocado</i>		Husky Roll	25
<i>On top: Spicy Tuna, masago, spicy mayo, scallion</i>		<i>Shrimp tempura, crab meat, cucumber, avocado topped with shrimp, unagi, spicy mayo, eel sauce</i>	
Avocado Roll	15	Killer Shrimp Roll	26
		<i>Inside: Shrimp tempura, crab, meat, cucumber, avocado</i>	
		<i>On top: Shrimp, avocado, sesame seed, spicy mayo</i>	

Caution raw seafood or raw shellfish Consuming raw or uncooked meats, poultry, seafood or eggs may increase your risk of food born illness

Chinese Entrees

Soup

Miso Soup	7
Won Ton Soup	14
Egg Flower Soup	13
(small)	7
Hot & Sour Soup **	16
Vegetable Noodle Soup	21
Spicy Seafood Noodle Soup **	24
Ramen	14

Fried Rice

Beef Fried Rice	19
Chicken Fried Rice	19
Pork Fried Rice	19
Shrimp Fried Rice	21
Vegetable Fried Rice	19
House Special Fried Rice	21

Chow Mein

Choice of Fried Noodle or Steamed Noodle

Beef Chow Mein	21
Chicken Chow Mein	21
Pork Chow Mein	21
Shrimp Chow Mein	23
Vegetable Chow Mein	21
House Special Chow Mein	23

Lo Mein

Beef Lo Mein	21
Chicken Lo Mein	21
Pork Lo Mein	21
Shrimp Lo Mein	23
Vegetable Lo Mein	21
House Special Lo mein	23

Vegetable

House Special Tofu **	23
Vegetable Deluxe	21

Beef

Mongolian Beef	23
Mushroom Beef	23
Szechuan Beef **	23
Broccoli Beef	23

Chicken

Garlic Chicken	21
Almond Chicken	21
Cashew Chicken	21
Kung Pao Chicken **	21
Sweet & Sour Chicken	23
Mushroom Chicken	21
Curry Chicken	21
Orange Chicken	23
Sesame Seed Chicken	23
General Tao Chicken **	23
Hot & Spicy Chicken **	23
Spicy Chicken Wings **	23

Pork

Sweet & Sour Pork	23
Hunan Pork **	23

Seafood

Kung Pao Shrimp **	26
Sweet & Sour Shrimp**	26
Szechuan Shrimp **	26
Curry Shrimp	26
Happy Family	28
Hot & Spicy Seafood**	28

**** Hot and Spicy**

Sandwich & Burger

Philly Cheese Steak — 21

Fresh prime rib, grilled mushroom, onions and peppers topped with cheese on a hoagie roll

Club Sandwich — 22

Roast beef on bougie roll served with Au jus sauce

Classic B.L.T. — 18

Bacon, lettuce, tomato on white bread

B.L.T. A. — 19

Bacon, avocado, lettuce, tomato on white bread

Grilled Cheese — 15

Hamburger — 15

Lettuce, tomato, onion, pickles and house sauce

Cheese Burger — 16

American Cheese, lettuce, tomato, onion, pickles, sauce

Bacon Cheese Burger — 17

Bacon, American cheese

French Onion Burger — 16

Grilled onions

Chili Cheese Burger — 18

Chili on top of patty with cheddar cheese

Bering Sea Burger — 19

A cheese burger with a fried egg, ham on top of lettuce, tomato, onion, pickles and house sauce

Mexican Burger — 18

With jalapeno, Onions, cheese topped salsa

Hawaiian Burger — 18

ham, lettuce, tomato, onion, pickle, cheese, pineapple

Blue Cheese Bacon Burger — 18

Smoked bacon with real blue cheese crumbles, lettuce, tomato, onion, pickles and mayo

Korean Bulgogi Burger — 20

With beef marinade in our special sauce

Chicken Teriyaki Burger — 18

Grilled chicken topped with teriyaki sauce and cheese

Fish Burger — 19

Breaded cod

Crispy Halibut Burger — 20

Fried halibut fillet dressed with lettuce, tomato, onion and tartar sauce

Mushroom Swiss Burger — 17

Mushroom, lettuce, tomato, onion, pickles, Swiss cheese

Korean / Japanese

Korean Galbi (Short Rib) — 37

Grilled beef short ribs served with Steamed rice

Korean Beef Bulgogi — 30

Korean style beef marinade in our special sauce

Spicy Pork Bulgogi ** — 29

Thin sliced and marinated in a sweet and spicy sauce

Chicken Katsu — 25

Salmon Teriyaki — 37

Chicken Teriyaki — 24

Served with steamed rice

Beef Teriyaki — 26

Served with steamed rice

Udon Japanese Soup — 16

Shrimp Tempura Udon — 18

Bento

Served with Green Cabbage Salad, California Roll, Fried Dumpling, Steamed Rice

Beef Teriyaki Box — 29

Chicken Teriyaki Box — 28

Galbi Box — 34

Salmon Teriyaki Box — 34

Beef Bulgogi Box — 30

Spicy Pork Bulgogi Box ** — 29

**** Hot and Spicy**

Starters

House Salad _____ **9**

Nacho Supreme _____ **21**

Natke tortilla chips with toco meats, cheese sauce, lettuce, tomato, sour cream, jalapeno, salsa

Chili Cheese Fries _____ **16**

Fries with chili cheese asure

Soft Pretzel with Cheese _____ **11**

Cheese Fries _____ **13**

Cheese Noches _____ **12**

Cheese Sauce as Nacho Chips

Deep Fried Chicken Wings _____ **16**

Curly Fries _____ **11**

Steamed Dumpling _____ **15**

Crab Ranggon _____ **12**

Egg Roll(2) _____ **10**

Pork, shredded vegetables wrapped in a dough made with egg and deep-fried

Buffalo Wings _____ **18**

deep-fried chicken wings coated in a spicy sauce

Mozzarella Sticks _____ **14**

Kimchee _____ **10**

Korean side dish made of spicy, fermented cabbage

Fried Dumpling _____ **15**

French Fries _____ **10**

Chicken Quesadilla _____ **15**

Tortilla filled with cheese, chicken cooked on gridille

Yummy Appetizer _____ **17**

Cream cheese, avocado, crab meat, spicy case and deep fried

Jalapeno Bomb _____ **15**

Spicy tata, cream cheese is jalapeno and deep fried

Monkey Brain * _____ **19**

Avocado with crab meat, spicy tuna, Masago

Avocado Bomb _____ **20**

Deep Fried with avocado, spicy tuna, crab meat

Edamame _____ **11**

Seaweed Salad _____ **15**

Musubi _____ **13**

Fried Shrimp _____ **19**

Baskets

Seafood Combo _____ **22**

Two pieces of cod, four jurt bo shrimps

Chicken Strips _____ **15**

Halibut and Chips _____ **22**

4PC Fried Chicken _____ **19**

6PC Jumbo Shrimp _____ **21**

3PC Fish and Chips _____ **18**

Chicken Nuggets _____ **14**

Vietnamese Soup

Served with Bean Sprout, Lemon, Pepper, Green Onion, Chien and cilantro

Beef & Meatball Pho _____ **22**

Beef, meatball and rice apodle in o beef broth

Beef pho _____ **21**

Meatball Pho _____ **22**

Seafood Pho _____ **23**

Shrimp, scallop and crab meat

Combo Pho _____ **24**

Beef, meatball and seafood in a soup

Chicken Pho _____ **21**

Stradaed chicken in a soup

Broccoli Pho _____ **21**

Plain Pho _____ **20**

BEER

Budweiser	7
Bud Light	7
Coors light	7
Alaskan Amber	8
Alaskan Icy-bay IPA	8
Corona	8
Heineken	8
Sapporo 12 oz	9
Sapporo 22 oz	13

WINE

Chadonnay	7.5
Merlot	7.5

HOT SAKE

Small Hot Sake	7
Large Hot Sake	12